

FOREST EMPEROR AND IRONWOOD

EcoVenues PROUDLY GREEN
GROOTVADERSBOSCH NATURE RESERVE



Originally known as Melkhoutskraal, the Grootvadersbosch Nature Reserve (GVB) encompasses 250 hectares of indigenous forest in the Langeberg region, close to Heidelberg. The name translates to “big father” in honour of Roelof Oelofse, who owned the land in 1723. GVB has only been a reserve since 1986 and was declared a World Heritage Site in 2004.

This is the most significant stretch of indigenous afro-montane forest left in the south-western Cape, with nearly all of the 35 typical forest tree species including red alder, ironwood, stinkwood and yellowwood. Visitors to this beautiful reserve will relish the opportunity to get out into the forest on day walks and mountain biking trails. The reserve is an excellent birding destination with more than 196 bird species regularly spotted. Hikers are likely to bump into bushbuck and spot baboons and smaller mammals when out on the trails. Sighting the forest emperor butterfly and a subspecies of the rare ghost frog, would be the highlight of a visit here, as they can only be found in this particular forest.



RESERVATIONS 087 087 8250



NATURE RESERVE

028 492 0001 OFFICE HOURS
082 496 2451 AFTER HOURS



OFFICE HOURS 07h00 - 16h00



OVERNIGHT BOOKINGS

CHECK IN 14h00 - 16h00 **CHECK OUT 10h00**



DAY BOOKINGS

CHECK IN 08h00 **CHECK OUT 16h00**



GATE TIMES 07h30 - 16h00

FOR SCHOOL GROUPS - a copy of the programme, list of learners and indemnity forms to be given to the officer on duty

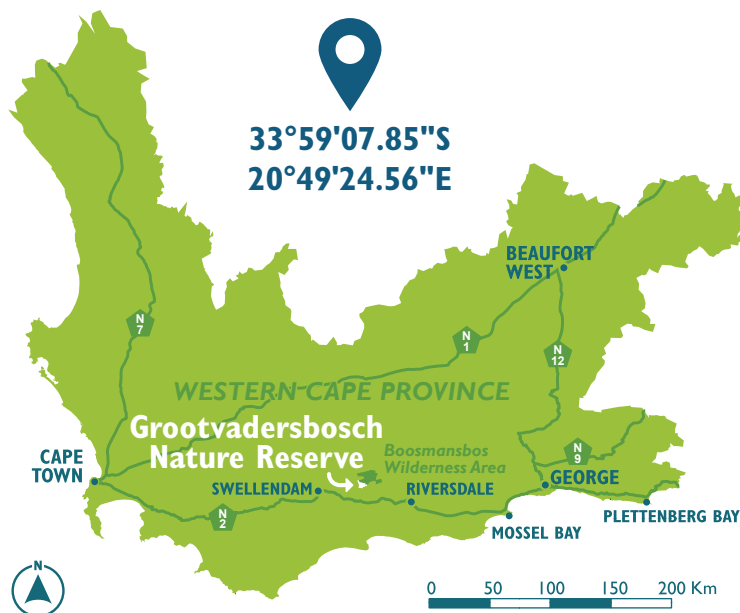

From Cape Town via N2

Proceed through Swellendam and Buffeljags River. Approximately 1km after the BP garage (on the right side), turn left at the Suurbraak/Barrydale signboard. Drive through the little town of Suurbraak. Continue on the tar road which will eventually become a gravel road. Go straight over the intersection, and continue until a T-junction. Turn left and continue along the gravel road. Keep left at the next fork in the road. Look out for the Grootvadersbosch direction signage. Do not turn off, as the road ends at the entrance gate to the reserve.

From George via N2

Two kilometres before Heidelberg (Engen Stop), turn right at the Barrydale – Tradouws Pass signboard. Continue with this road (R322) that leads through the town. Do not turn off into any street. Continue straight through with the R322. Continue through town and over a railway crossing. The R322 eventually becomes a gravel road. Approximately 4km from where the gravel road started, turn right at the Grootvadersbosch sign on the R322. Continue with this gravel road and keep left at a fork in the road. Look out for the Grootvadersbosch direction signage. Do not turn off as the road ends at the entrance gate to the reserve.



THERE IS NO SHOP ON THE RESERVE. FOOD, BEVERAGES AND OTHER PROVISIONS MUST BE BOUGHT BEFOREHAND.

FOREST EMPEROR ECO-VENUE

PURPOSE



CAPACITY

60 cocktail style

45 conference style

FACILITIES

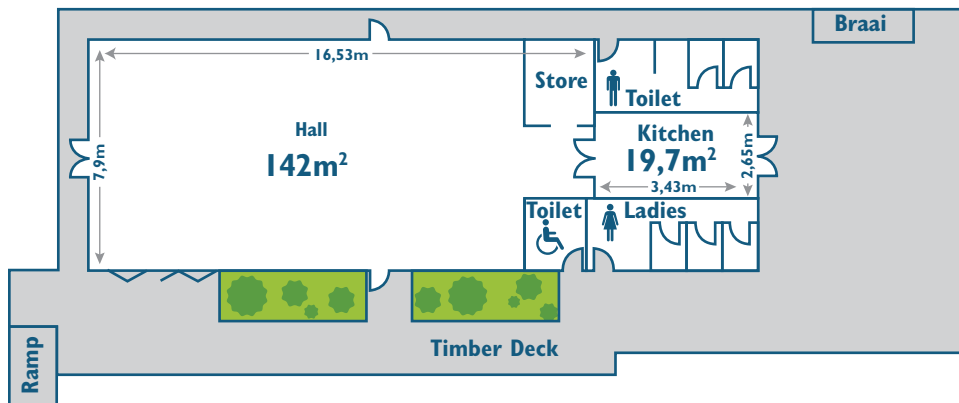

IRONWOOD ECO-VENUE

Booked with/without the use of adjacent dormitory accommodation

PURPOSE



CAPACITY

40 if using dorms

50 day visitors
cocktail style

FACILITIES

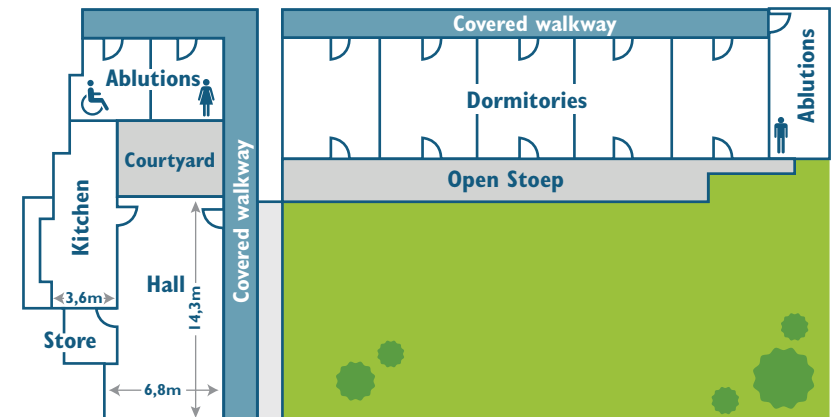

ACCOMMODATION ON SITE

Dormitory accommodation is also available at the Ironwood Eco-Venue

RESERVATIONS



087 087 8250
www.capenature.co.za



CABINS x11
2 BEDROOMED

CAPACITY
48

x7 4-SLEEPERS DOUBLE BED + 2x SINGLE BEDS

x4 5-SLEEPERS DOUBLE BED + SINGLE BED + DOUBLE BUNK



BEDDING + TOWELS



FIREPLACE



EQUIPPED KITCHEN



LOUNGE



BRAAI PLACE



BRAAI GRID



CAMPSITES x10
CAMPSITES WITH ABLUTIONS x2

10 CAMPSITES

- View of indigenous forest
- Opportunities for bird watching
- Children's play area/jungle gym
- Individual braai sites
- Communal ablution facilities
- Thatched communal braai area with a fridge



BRAAI PLACE



COMMUNAL



COMMUNAL



PLAY AREA

PLUS



FRIDGE



BRAAI AREA



SCOLOPIA COTTAGE

CAPACITY 6

- Fully equipped, 2-bedroomed wooden house
- Situated on the edge of the forest near the entrance of the reserve and the start of a day trail

1x DOUBLE BED
2x DOUBLE BUNKS



BEDDING + TOWELS



FIREPLACE



EQUIPPED KITCHEN



LOUNGE



BRAAI PLACE

2 CAMPSITES WITH ABLUTIONS

- Situated apart from the main campsite (no shade)
- The 2 sites are screened off by a wooden fence divider
- Electricity and electrical points
- Built in braai place, scullery and cupboard
- Private shower and flush toilet
- No fridge or cooking equipment



SHOWERS



TOILET



ELECTRICITY



SCULLERY



CUPBOARD



NO FRIDGE



BRAAI PLACE

ECO-PROGRAMMES

AVAILABLE ON REQUEST

Our approach to environmental education is based on active participation where learners are encouraged to learn about the environment through

discovery | questioning | problem solving | critical thinking



ENVIRONMENTAL EDUCATION PROGRAMMES

- At the Ironwood Eco-Venue, subject to availability
- Curriculum aligned programmes available on request
- Must be pre-arranged and booked prior to arrival
- Can be self-guided or facilitated

FACILITATED

- Programme run by CapeNature
- 7 days a week (Subject to availability)

SELF-FACILITATED

- Programme run by group organiser
- 7 days a week
- A recommended programme can be provided

GROUPS NEED TO PROVIDE OWN TRANSPORT TO AND FROM ALL ACTIVITIES.

PARTS OF THE RESERVE HAVE STEEP TERRAIN



ACTIVITIES

SELF-FACILITATED



DAY WALKS

- Bushbuck and Grysbok Trails
- From 10 – 15km



SWIMMING

- In the nearby Duiwenhoks River
- At the swimming pool at the cabins (not for the use of groups booked at the Ironwood Eco-Venue)



MOUNTAIN BIKING (BRING YOUR OWN BIKE)

- 6km cycle trail on the reserve
- Various MTB trails available on the adjacent Grootvadersbosch Conservancy Area (requires a permit, available from the Conservancy Office)



BIRD WATCHING

- 2 bird hides
- More than 196 bird species regularly spotted at the reserve

CHECKLIST: WHAT TO BRING

ALWAYS BRING THESE ITEMS



BOOKING CONFIRMATION

This is your entry permit



SIGNED INDEMNITY FORMS



FOOD + DRINKS



EXTRA TOILET PAPER



FIREWOOD



MATCHES + FIRELIGHTERS



CHARCOAL



FIELD MEDICAL KIT



DISHWASHING LIQUID

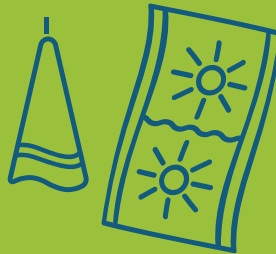

TOWELS



SWIMMING COSTUME
(Cabin guests only)



WALKING SHOES



SUN HAT



SUNSCREEN



WATER BOTTLE



**WARM JACKET/
RAINCOAT (Winter)**

ALSO BRING THESE ITEMS IF STAYING OVERNIGHT AT THE IRONWOOD ECO-VENUE



PLATE, MUG, CUTLERY

(unless requested directly from the reserve, prior to arrival)

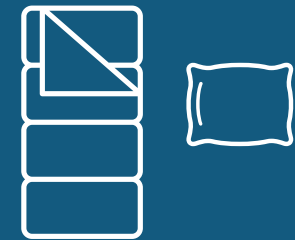

SLEEPING BAG + PILLOW



TOILETRIES



PEN + NOTEBOOK



TORCH