

Deducted No. 107
 (Sgd.) W.P. Murray
 Registry Surveyor and Examiner
 18. Jan. 1910.

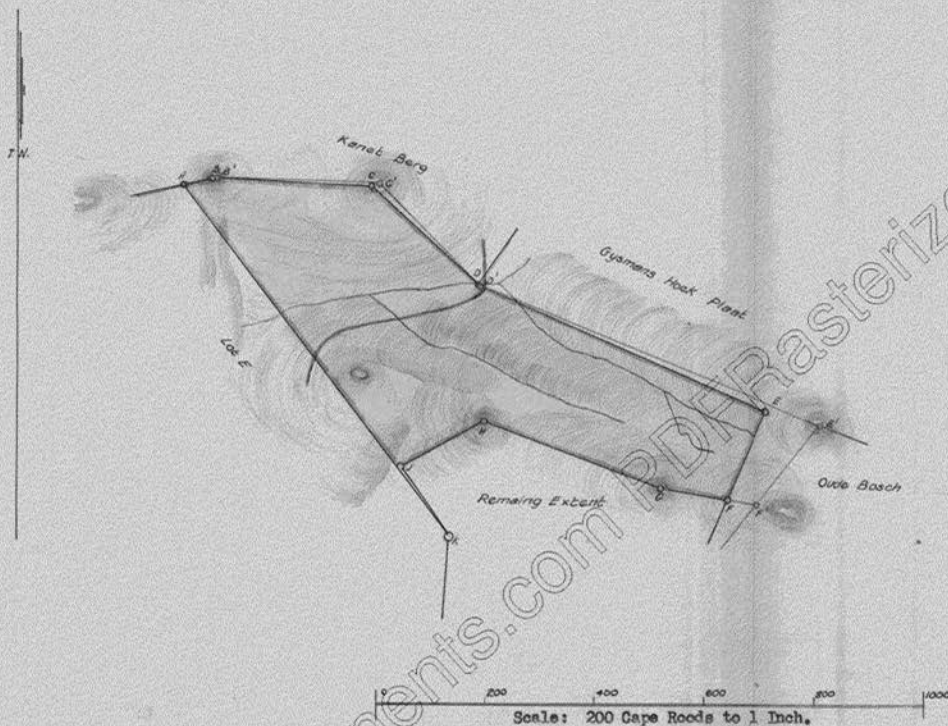

| Data as per Beacons. | | | |
|----------------------|---------|-----------|--|
| Coordinates | | | |
| | Y | X | |
| A | 1193 34 | - 412 74 | |
| B | 1205 12 | - 471 39 | |
| C | 1193 20 | - 770 61 | |
| D | 1003 60 | - 953 04 | |
| E | 735 83 | - 1577 31 | |
| F | 605 95 | - 1462 48 | |
| G | 638 57 | - 1284 39 | |
| H | 760 42 | - 962 46 | |
| J | 678 95 | - 804 63 | |
| K | 552 47 | - 896 66 | |

| Angles | | Sides | |
|--------|-----------|-------|--------|
| | ° ' " | C. | Roods |
| A | 64 17 50 | AB | 59 83 |
| B | 166 22 0 | BC | 299 46 |
| C | 136 10 40 | CD | 263 12 |
| D | 202 53 10 | DE | 679 28 |
| E | 71 44 10 | EF | 173 36 |
| F | 121 6 0 | FG | 181 05 |
| G | 169 39 0 | GH | 344 22 |
| H | 228 2 0 | HJ | 177 62 |
| J | 278 44 20 | JK | 156 42 |
| K | 1 0 50 | KA | 803 04 |

Area - 466 Morgen 481 Square Rods.

Portion 6
 (a portion of Portion ...) of the farm
 Hottentots Bosch No 80
 RIVERSDALE

The above Diagram A.B.C.D.E.F.G.H.J.K. represents 436 Morgen 200 Square Rods, situate in the Field-Cornetcy of VETTE RIVIER, Division of RIVERSDALE being Lot F of the Farm HOTTENTOTS BOSCH, Granted to E.J. Erasmus on the 1st. February 1845.

Bounded:- N. by Kanet Berg
 S. " Remaining Extent
 S.E. " Oude Bosch and Remaining Extent
 S.W. " Lot E
 N.E. " Kanet Berg and Gysmans Hoek Plat

Surveyed and beaconsed by me according to regulations

(Sgd.) Wilson Greathed
 Government Land Surveyor

Novr. 1909.

Copied from the diagram relating to
 Transfer from Deed No. 2253
 8th. April, 1911.
 in favour of
 Jacobus Frederik van Wyk.
 W.P. Karawick
 SURVEYOR-GENERAL
 CAPE TOWN
 p. 6. 1950.

MADESEN
 DEDEWENS MADESEN
 26-4-60 54

Vol. No. 37