



De Hoop Nature Reserve's diversity of landscapes, ranging from mountains, fresh water streams and a large vlei, to a long stretch of coastline. The reserve is ideally suited for environmental education.

De Hoop is 36 000 ha in extent, with over 1 500 plant species, 86 mammal species (including the rare bontebok and Cape mountain zebra), approximately 260 bird species (including the Cape vulture) and nearly 50 reptile species. The adjacent De Hoop Marine Protected Area is one of the best land-based whale watching sites in the world.

The Potberg area is steeped in history. Early indigenous people were attracted by the supply of fresh water and the plentiful game. The first recorded European inhabitant of the area was Christoffel Groenewald who was granted a grazing license in 1730. Anders Ohlsson, of Ohlsson's Breweries fame, built the original Cape Dutch thatched homestead in the late 1800s. Potberg has many interesting features, one being the San (Bushman) painting in the cave above the homestead. Scattered throughout the reserve are other signs of their existence, including shell middens on the sand dunes and in the caves, along the limestone cliffs on the coast.

Cape vultures are often seen soaring overhead the Klipspringer Trail, either on their way out to forage, or returning to the kloof.



	RESERVATIONS 087 087 8250
	087 087 4004/6 OFFICE HOURS 082 496 3443 AFTER HOURS
	OFFICE HOURS 07h30 - 16h00
	CHECK IN CHECK OUT 14h00 - 16h00 10h00
	CHECK IN CHECK OUT 08h00 16h00
	GATE TIMES 07h30 - 16h00 FOR SCHOOL GROUPS - a copy of the programme, list of learners and indemnity forms to be given to the officer on duty



From Cape Town via N2

Take the N2 from Cape Town to Caledon. Turn right at the second turn off to Caledon, where you will find the Venster Restaurant on your left side. Drive through Caledon and then continue on the R316 to Bredasdorp, via Napier. At the 3rd 4-way stop street in Bredasdorp, turn left into All Saints Street (Engen garage on left corner). Travel approximately 8 km on the R319 to Swellendam (past the silos on right hand side). Turn right onto the gravel road signposted Wydgeleë, Infanta, Malgas and De Hoop. Travel for approximately 50 km straight on to Potberg. (Do not turn right at the sign posted De Hoop Pad). Go past Ouplaas School. **DO NOT** turn to Malgas. Drive straight. Pass Verfheuwel farm. Potberg gate is approximately 10 km from the school. Once you enter the reserve, follow the public entrance signs at the Y-junction to the office.

From George via N2

From George, follow the N2 to Swellendam. Approximately 10 km past Swellendam, take the Spitskop turn off and follow this gravel road for 31 km, until you reach a T-junction. (This will be the road going from Potberg to Bredasdorp). Turn left here and follow the road to Potberg for about 12 km. (Do not turn right at the sign posted De Hoop Pad).



THERE IS NO SHOP ON THE RESERVE. FOOD, BEVERAGES AND OTHER PROVISIONS MUST BE BOUGHT BEFOREHAND.

ACCOMMODATION ON SITE

RESERVATIONS



087 087 8250
www.capenature.co.za



POTBERG ECO-VENUE

CAPACITY

65

OVERNIGHT + DAY BOOKINGS

FACILITIES



COACH PARKING



HALL



FULL SERVICE
[self-catering]



GENERATOR



ELECTRICITY



DATA PROJECTOR
[on request]



BRAAI PLACE



COMMUNAL



COMMUNAL



BEDS +
MATTRESSES



BEDS +
MATTRESSES

100x pieces of firewood are provided on arrival. Additional firewood should be brought with you.

2x rolls of toilet paper are provided in each cubicle. Additional toilet paper should be brought with you.

KITCHEN

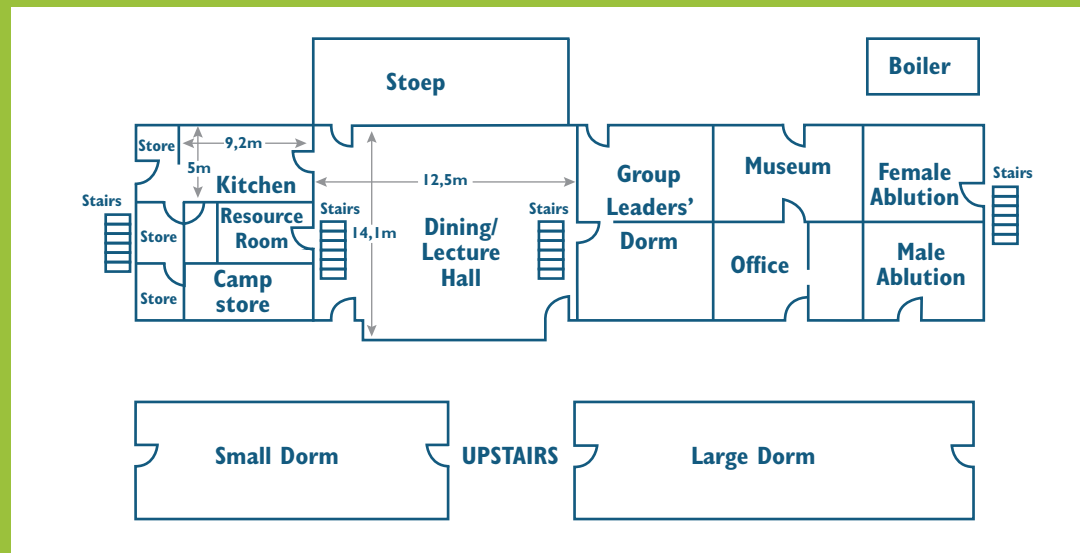
 TABLEWARE
 FRIDGE
 GAS STOVE
 MICROWAVE
 COOKWARE
 NO DISH CLOTHS OR DETERGENT
 FREEZER

Guests may combine rooms as needed.
Capacity remains 65.

GROUP LEADERS' DORM
(DORM IS DIVIDED INTO 2 SECTIONS) x9

LARGE DORM x48

SMALL DORM x23

ECO-PROGRAMMES

AVAILABLE ON REQUEST

Our approach to environmental education is based on active participation where learners are encouraged to learn about the environment through

discovery | questioning | problem solving | critical thinking



ENVIRONMENTAL EDUCATION PROGRAMMES

CAPACITY

25-60 learners + 2-8 leaders

- Curriculum aligned programmes available on request
- Must be pre-arranged and booked prior to arrival
- Can be guided or self-guided

FACILITATED

- Programme run by CapeNature
- 7 days a week (Subject to availability)
- Includes mountain and coastal hikes with studies of fynbos ecology, invasive plants, tidal pools, dunes and the De Hoop Vlei

SELF-FACILITATED

- Programme run by group organiser
- 7 days a week (Subject to availability)
- A recommended programme can be provided



GROUPS NEED TO PROVIDE OWN TRANSPORT TO AND FROM ALL ACTIVITIES
e.g. Koppie Alleen, visiting De Hoop Vlei etc.

ACTIVITIES



DAY WALKS

- Klipspringer Trail 6km
- Potberg Trail 6km



SWIMMING

- The clear rock pools along the De Hoop coastline are ideal for swimming and snorkelling.



WHALE WATCHING

- The De Hoop Marine Protected Area is a breeding ground for southern right whales and is one of the best land-based whale watching sites in the world.



OVERNIGHT TRAIL

- The 5-day Whale Trail starts at Potberg (BOOKING ESSENTIAL). Whale Trail cottages located along the route lie at the foot of the Potberg mountains. Each fully equipped cottage sleeps up to 12 people, generally with 3 bedrooms (4 beds each).

EMERGENCY NUMBERS



Fire and Rescue
Otto Du Plessis Hospital (Bredasdorp)
Swellendam Hospital

028 425 1690
028 424 1167
028 514 1141

CHECKLIST: WHAT TO BRING

ALWAYS BRING THESE ITEMS



BOOKING CONFIRMATION

This is your entry permit



SIGNED INDEMNITY FORMS



FOOD + DRINKS



EXTRA TOILET PAPER



FIREWOOD



MATCHES + FIRELIGHTERS



CHARCOAL



FIELD MEDICAL KIT



DISHWASHING LIQUID

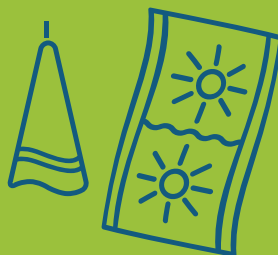

TOWELS



SWIMMING COSTUME



WALKING SHOES



SUN HAT



SUNSCREEN



WATER BOTTLE



**WARM JACKET/
RAINCOAT (Winter)**

ALSO BRING THESE ITEMS IF STAYING OVERNIGHT AT THE POTBERG ECO-VENUE



PLATE, MUG, CUTLERY

(unless requested directly from the reserve, prior to arrival)

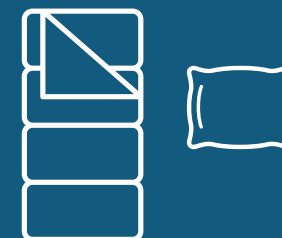

SLEEPING BAG + PILLOW



TOILETRIES



PEN + NOTEBOOK



POCKET MONEY



TORCH