

SIDES metres	ANGLES OF DIRECTION	CO-ORDINATES			
		Y	System: Lo 23°	X	
		Constants	+0, 00	+3 700 000, 00	
A B	1070, 64	267.15.10	A	-44 833, 51	+60 329, 77
B C	1231, 85	1.11.07	B	-45 902, 92	+60 278, 45
C D	1486, 56	84.57.34	C	-45 877, 44	+61 510, 04
D A	1381, 76	198.25.55	D	-44 396, 63	+61 640, 65
Indicatory Data					
C E	0, 31	264.57.34	E	-45 877, 75	+61 510, 04
D F	72, 75	264.57.34	F	-44 469, 10	+61 634, 26
(72) Sappers Hill			△	-44 618, 82	+62 536, 25
(155) HUM 14			△	-45 706, 56	+60 185, 37

SG No.

1280/95

Approved

R. K. ...

for

**SURVEYOR-
GENERAL**

1995-04-21

BEACON DESCRIPTIONS

Sheet 1 of 2 Sheets

- A Half iron standard with circular trench
- B Prismoidal concrete beacon with square hole in centre
- C ... Calculated point - not beaconsed
- D, E, F. 15mm Iron peg in stones

COMPONENTS

- (1) The figure A B x y z D represents the remainder of Farm No. 301
Vide diagram 580/1845 D/G Kn. 9.444 Kn. Q. 1/1
- (2) The figure x C z y represents Portion 1 of the Farm No. 471
Vide Diagram 1279/95 D/T 1995 - 68511

The figure A B C D
represents 159,9935 hectares of land being
FARM NO. 495

and comprises (1) and (2) as shown above
situate in the Greater Plettenberg Bay Transitional Local Council Area
Administrative District of Knysna
Province of Cape of Good Hope
Surveyed in December 1953

R L Barry

by us

and January 1995
H. van Waart

R L Barry

H van Waart

Professional Land Surveyor (PLS 0090)

Professional Land Surveyor (PLS 0607)

This diagram is annexed to
No. T 68513/95
d.d.
i.f.o.

Registrar of deeds

The original diagrams are
as quoted above

File Knys 495
S.R. No. E110/54 &
E423/95
Comp. BM - 7000 (4185)

Farm No. 495
Administrative District of Knysna

SG No.

1280/95
Approved

R. Roumoff

for
SURVEYOR-
GENERAL

1995-04-21

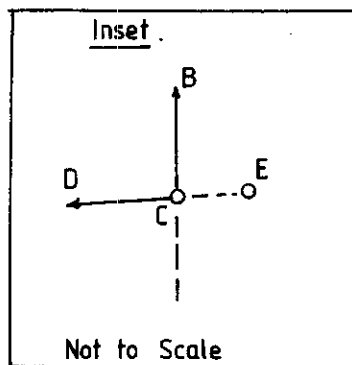
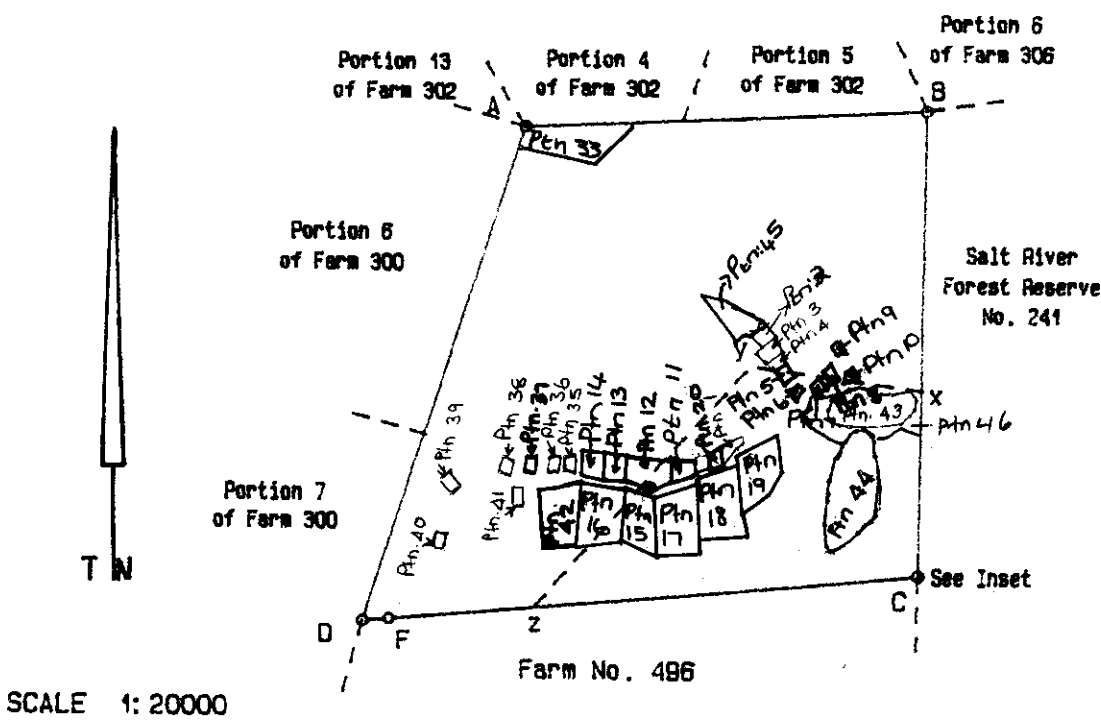

Surveyed in December 1953

R L Barry
R L Barry

Professional Land Surveyor (PLS 0030)

by us

H van Waart
H van Waart

Professional Land Surveyor (PLS 0607)

and January 1995

THE FOLLOWING DEDUCTIONS HAVE BEEN MADE FROM THIS DIAGRAM

SURVEY RECORD	DIAGRAM NO.	SUBDIVISION	AREA HA./SQ. M.	TRANSFER NO.	INITIALED	REMR.
E1190/97	3065/97	Ptn. 1				
"	3066/97	" 2				
"	3067/97	" 3				
"	3068/97	" 4				
"	3069/97	" 5	1618	111511/97	} WT.	
"	3070/97	" 6	1089	111512/97		
"	3071/97	" 7	819	111513/97		
"	3072/97	" 8	1049m ²	35426/03	WT.	
"	3073/97	" 9	726	40805/98	OH	
"	3074/97	" 10	950	16212/98	OH	
"	3075/97	" 11	3600	57639/00	OH.C	
"	3076/97	" 12	8708m ²	48518/2002	WT.	
"	3077/97	" 13	3855	16213/98	OH	
"	3078/97	" 14	3744	111514/97	WT.	
"	3079/97	" 15	1,2832	22764/99	OH	
"	3080/97	" 16	1,8155	11151/97	WT.	
"	3081/97	" 17	1,9750	22765/99	OH	
"	3082/97	" 18	1,9529	81297/99	OH	
"	3083/97	" 19	1,5423	111515/97	WT.	
"	3084/97	" 20	1324m ²	56401/2001	JK	
E3098/08	6888/08	Ptn. 33	1,9947ha	47410/18	D.C	
"	6889/08	" 34		WITHDRAWN		
"	6890/08	" 35				
"	6891/08	" 36				
"	6892/08	" 37	1200 sq.m	8031/2011	JK	
"	6893/08	" 38				
"	6894/08	" 39				
"	6895/08	" 40				
"	6896/08	" 41				
"	6897/08	" 42		68514/1995	JA	
"	6898/08	" 43				
"	6899/08	" 44	3,1582ha	62188/14	JA	
485/2016	787/2016	Ptn 45	8463 Sqm	110240/2011	JA	
"	788/2016	" 46	1,5098 ha			